

DRAWINGS (mm)

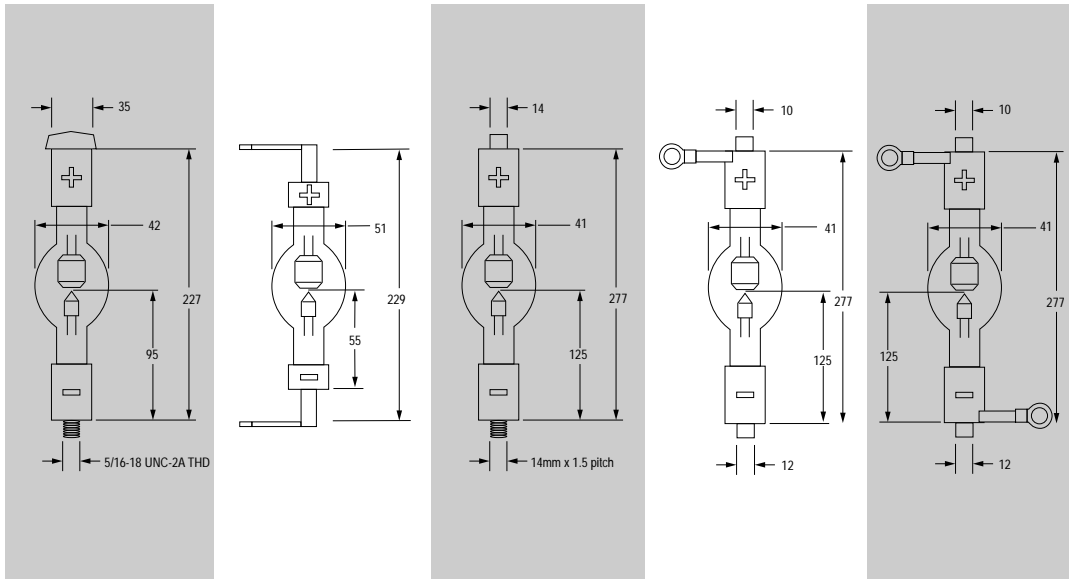

PART NUMBER

1KWMILITARY

AC-1000W

XM1000HTP

XM1000H/VC

XM1000H/VCC

SPECIFICATIONS

POWER (W)

1000

1000

1000

1000

1000

CURRENT(A)

47

18

45

50

50

VOLTAGE (V)

20

65

22

20

20

IGN. VOLTAGE (V)

30K

20K

25K

25K

25K

MINIMUM OPEN
CIRCUIT VOLTAGE (V)

60+

70+

80+

80+

80+

AVERAGE LUMEN OUTPUT

32,000

50,000

35,000

32,000

32,000

AVERAGE LIFE
(HOURS)

1000

1000

2000

2000

2000

MIN/MAX CURRENT (A)

40/44

14/18

42/52

40/55

40/55

ARC GAP (mm)

3.5

7.4

3.4

3.4

3.4